

# Terrano.2258 – Product Specification



## Terranos net landscapes – straight posts and connecting elements

Our netscapes offer children of all ages plenty of space for any kind of climbing, crawling, balancing and other physical activities. The highly accessible components are also the ideal place to get engaged in imaginative play or just hang around and relax.

The range of rope accessories can turn any space into a netscape. Whether straight or sloping, there is always space for a two-dimensional or a hand-over-hand climbing component. And if a tree should be in the way, we simply integrate it and make it the focal point of your playground

### Terrano.2258 – At a glance.

Product Family:	<b>Terranos &amp; Terranova</b>	Number of Foundations:	<b>19 pc.</b>
Item Number:	<b>95.172.258</b>	Concrete Volume C20/C25:	<b>13,6 m<sup>3</sup></b>
Children's Age:	<b>5+</b>	Number of skilled installers required:	<b>4</b>
Fall Height (DIN EN 1176):	<b>2.4 m (7'-10")</b>	Installation Time without foundation:	<b>20 hours</b>
Length x Width x Height:	<b>12.0 m x 6.6 m x 4.0 m (39'-5" x 21'-9" x 13'-2")</b>	Dimensions of largest part:	<b>5.0 m x Ø 0.1 m</b>
Protective Surfacing Area (DIN EN 1176):	<b>15.7 m x 10.8 m</b>	Weight of heaviest part:	<b>150 kg</b>
Protective Surfacing Area (ASTM 1487):	<b>15.7 m x 10.3 m (51'-6" x 33'-9")</b>	Shipping Volume:	<b>Upon request</b>
Minimum space required DIN EN 1176:	<b>156 m<sup>2</sup></b>	Spare part guarantee:	<b>Lifelong</b>
Minimum space required ASTM 1487:	<b>158 m<sup>2</sup></b>	Certificate according to DIN EN 1176:	<b>No.: Z2.16.01.10256.255 TÜV Product Service</b>

  
**Berliner**  
 Berliner Seilfabrik  
 Play Equipment Corporation  
 96 Brookfield Oaks Drive, Suite 140  
 Greenville, SC 29607

T + 1 864 627 1092  
 F + 1 864 627 1178

[www.berliner-playequipment.com](http://www.berliner-playequipment.com)  
[info@berliner-seilfabrik.com](mailto:info@berliner-seilfabrik.com)

# Terrano.2258 - Product Specification

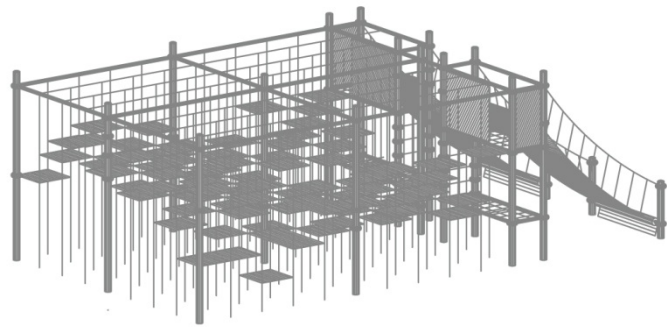
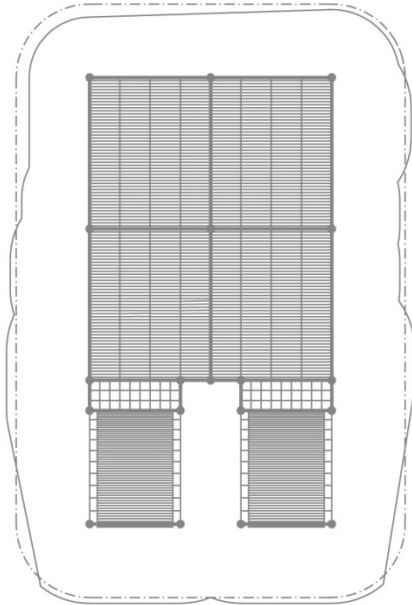

M 1:200

## Technical Data.

The following text can also be used for tenders.

- Rubber elements in different heights
- Planar nets
- Towers
- Rubber ramps

### Posts:

Steel pipes  $\varnothing$  133 mm (5 1/4"); wall thickness 5 - 10 mm (3/16" - 3/8") with a round cast aluminum post top; anti-corrosion treatment and color finish: sandblasting and solvent-free zinc-/ epoxy-/ polyester-process

### Terranos clamps:

Two-part cast aluminum connecting clamps for the height-adjustable connection of rope elements or steel pipes to Terranos steel posts; anti-corrosion treatment and color finish: sandblasting and solvent-free zinc-/ epoxy-/ polyester-process

### Ropes:

U-Rope®-round strand ropes with galvanized and covered wires: external strands with non-abrasive UV-resistant Polyester-yarn (no Polypropylene); rope-diameter  $\varnothing$  16 mm (5/8")

### Tube framework:

Framework-steel tubes,  $\varnothing$  60.3 mm (2 3/8"); anti-corrosion treatment and color finish: sandblasting and solvent-free zinc-/ epoxy-/ polyester-process

### Planar nets:

Rope  $\varnothing$  16mm (5/8"); mesh size minimum 250 x 250 mm (9-4/5"); rope crossing points localized by durable, drop forged aluminum ballknots (no plastic)

### Rubber membranes:

Rubber comprised of durable, vandal-resistant conveyor belt material; rope  $\varnothing$  16 mm (5/8")

### Wall panels:

HDPE-panel, thickness 19mm (3/4")

### Rubber ramps:

Rubber comprised of durable, vandal-resistant conveyor belt material; rope  $\varnothing$  16 mm (5/8"); climbing handles: HDPE

  
**Berliner**

Berliner Seilfabrik  
Play Equipment Corporation  
96 Brookfield Oaks Drive, Suite 140  
Greenville, SC 29607

T + 1 864 627 1092  
F + 1 864 627 1178

www.berliner-playequipment.com  
info@berliner-seilfabrik.com

